

Sample Fence Calculations

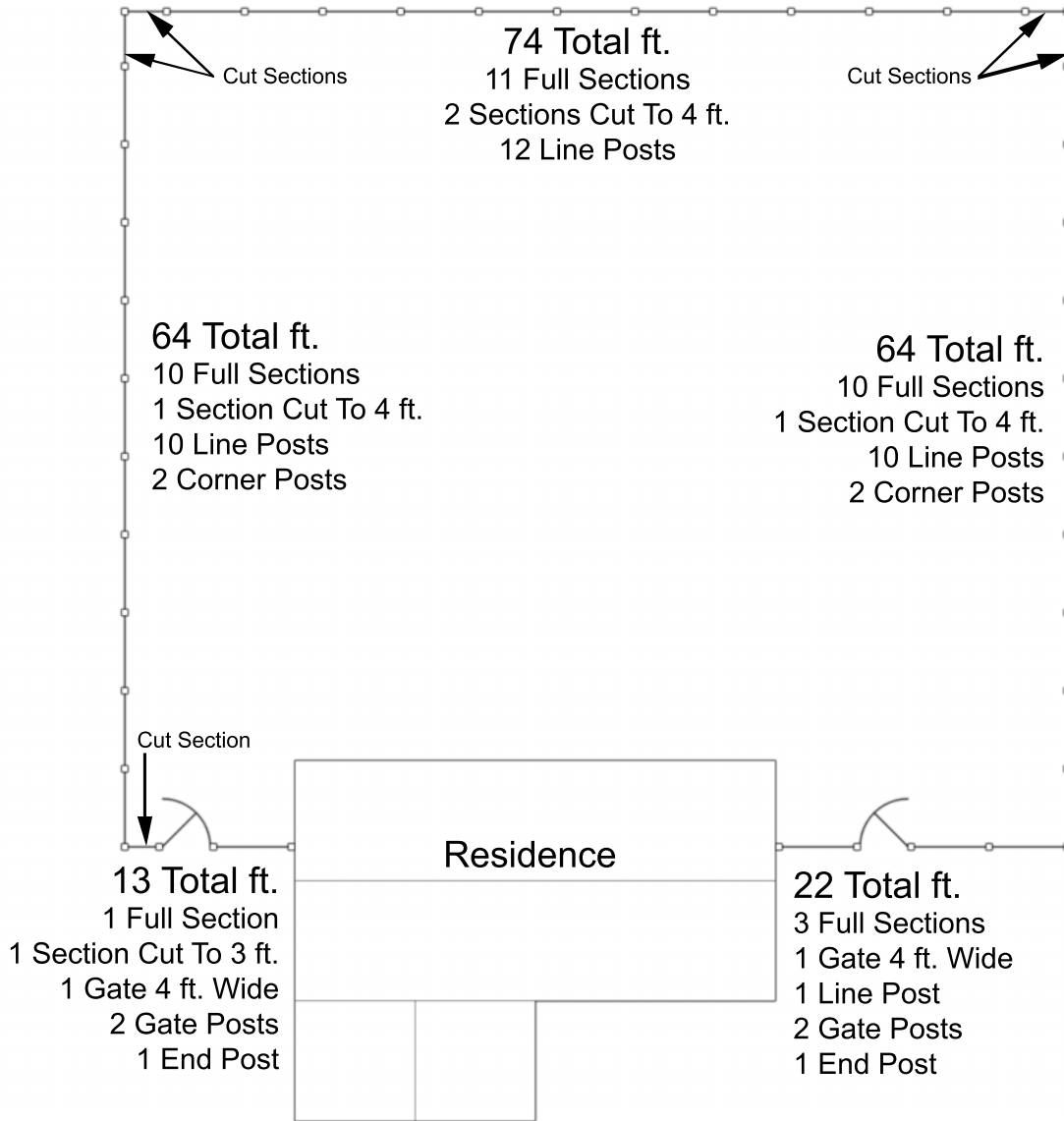

Sample Calculation For The Above 13 ft. Run
 13 ft. - 4 ft. wide gate = 9 ft.
 9 ft. ÷ 6 (section length) = 1.5 Sections
 1 Full Section & 1 Cut Section

Sample Calculation For The Above 22 ft. Run
 22 ft. - 4 ft. wide gate = 18 ft.
 18 ft. ÷ 6 (section length) = 3 Full Sections

Total Materials Needed

- (40) Fence Sections (5 sections to be cut)
- (2) 4 ft. Wide Gates
- (33) Line Posts
- (4) Corner Posts
- (2) End Posts
- (4) Gate Posts

All of our residential fence sections are 6 ft. long. Post mounting is 72.5" on centers. Fence sections can be easily cut using a hacksaw or sawzall.