

## Commercial Aluminum Posts

### Specifications

Material: 6063-T5 Aluminum • Available In Line, End, Corner, "T" & Gate Post Configurations • PPG® TGIC Polyester Powder Coating

Screws: Hardened 410 Stainless Steel With Cr6 Plating & Colored Heads

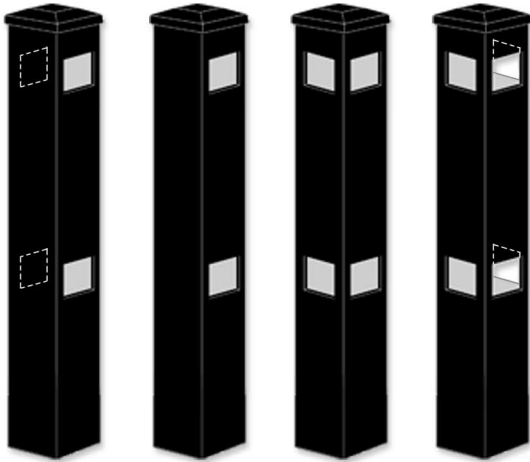

Line Post

End/Gate Post

Corner Post

T-Post

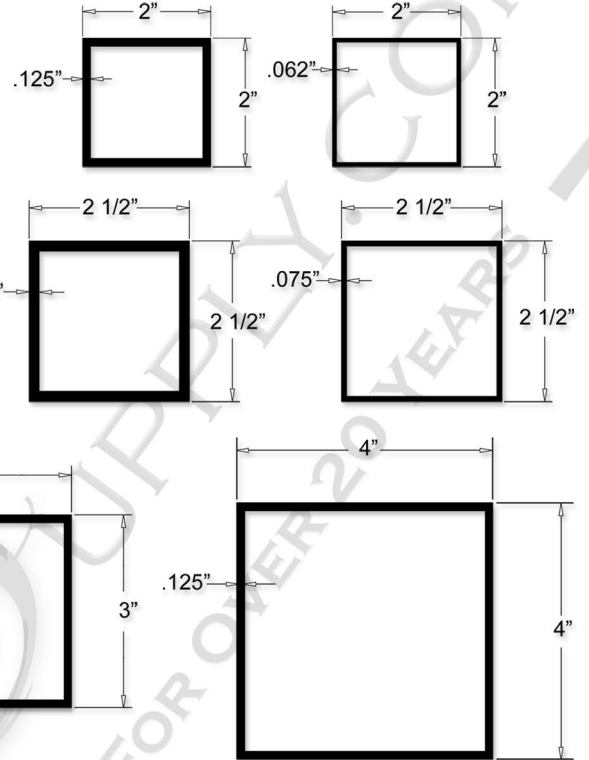

Line Post

(Connects Fence Sections In A Straight Line.)



End/Gate Post

(Ends A Fence Line  
 Gate Post Ends A Fence Line & Attaches A Gate)

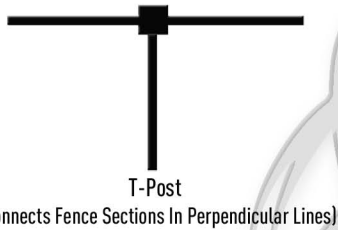

T-Post

(Connects Fence Sections In Perpendicular Lines)

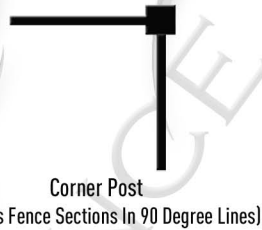

Corner Post

(Connects Fence Sections In 90 Degree Lines)



Flat Cap

Ball Cap

Solar Cap

### Available Post Sizes

- 2" x 2" x .062" & .125" Wall
- 2 1/2" x 2 1/2" x .075" & .125" Wall
- 3" x 3" x .125" Wall
- 4" x 4" x .125" Wall

### Post Lengths

- 70" Length For 36" & 48" Height Fence Sections
- 84" Length For 54" & 60" Height Fence Sections
- 96" Length For 72" Height Fence Sections